

Bayfield County Forestry & Parks Department

Forester: Caleb E. Brown			Compartment: 196	Stand: 19 & 24	Tract Number: 35-21
Twp: T43N	Range: R7W	Sec: 28, 29 & 32	Township: Cable	Contract Number:	
Topography: Moderate Slopes and Gently Rolling			Reforestation Code: NA	Soil: Sandy Loam	Acres: 80

Estimated Volumes			
Species	Whole Tree (Tons)	4" Roundwood (Tons)	Sawlogs (MBF)
Red Oak	3985	3127	163
Mixed Hardwood	3653	2730*	72
Aspen	735	611	-

*47% Hard Maple, 27% Red Maple, 19% Basswood, 5% Yellow Birch, 1% White Birch, and 1% Other
 **45% Basswood, 44% Sugar Maple, 10% Red Maple, and 1% Other

Other
 -Good Summer Chance (Dry) or Frozen Operations Only
 -Oak wilt restriction (see suplimental requirements)
 -No operations when snow depth is 2" or greater

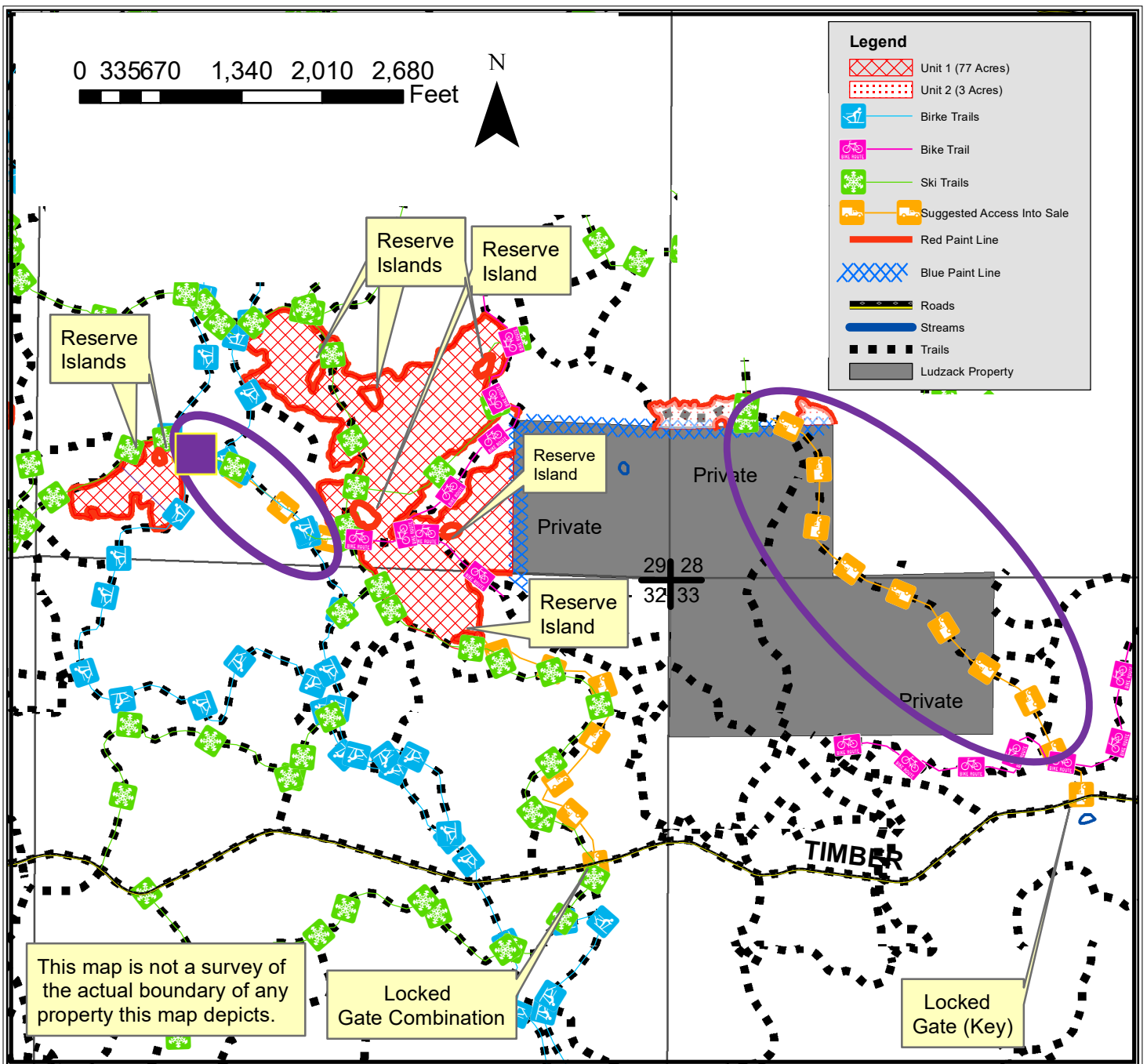

TRACT 35-21 – SUPPLEMENTAL REQUIREMENTS

The following terms and conditions supplement those provided in the Bayfield County Timber Sale Contract.

A. PRESCRIPTION:

1. Unit 1 (77 acres) has a seed tree and reserve island prescription with conifer and oak reserves and an estimated average residual basal area of 13 sq ft.
2. Unit 2 (3 acres) has a shelterwood prescription with oak and conifer reserves with an estimated average residual basal area of 33 sq ft.

B. HARVEST REQUIREMENTS:

1. Unit 1, harvest all hardwood stems 2 inches and greater except for purple painted trees. Purple painted trees are adjacent to ski and bike trails. Leave all conifer.
2. Unit 2, harvest all hardwood stems 2 inches and greater except for except purple painted trees. Purple painted trees are adjacent to ski trails. Leave all conifer.

C. HARVEST AND OPERATIONAL REQUIREMENTS AND SEASONAL RESTRICTIONS:

1. Good summer chance operations only (dry or frozen ground operations as determined by the county).
2. No sale operations between April 1st and July 15th (Oak Wilt restriction).
3. No sale operations on ski trails permitted when there is more than 2" of snow on the ground.
4. Portions of the roads on this timber sale are used as cross-country ski trails in the winter. Due to incompatibility with skis, fractured rock may not be placed on the ski trail sections. Crushed gravel, approved by the sale administrator, is permitted.
5. Skidding across the recreational trails will only be allowed in designated areas as determined by the sale administrator.
6. Access to the eastern portion of the sale involves crossing private property. The county has an easement to cross this property.
7. All trails must be returned to original, pre-sale condition as determined by the sale administrator.
8. Slash to be no greater than 18" from the ground within 25 feet of the trail(s). No slash on trail(s).
9. Utilization specification is to a 4" top. However, if the County determines that pulpwood markets continue to be very poor at the time of harvest the County will sign a contract amendment with the purchaser changing the utilization specification to a 5" top for the selected species. When determining condition of the market, the County will pay particular attention to the amount of wood being purchased by the mills in Wisconsin Rapids and any other significant shifts in the wood demand.
10. Sale boundaries include red and blue paint line along with a ski trail and stark transitions to an origin year 2008 white pine stand.
11. If harvest will utilize the whole tree, 1 in 10 tops must be left scattered throughout the sale.
12. Do not damage any survey monumentation.

D. ACCESS AND ROADS:

1. This sale will be accessed through two different gates (see sale map) off of timber trail road. One gate requires a key the other a combination. Bayfield County will provide the key and combination code for the respective gates.
2. Already established ski trails and roads can be used to access timber sale. All ski trails and haul roads must be returned to original, pre-sale condition as determined by the sale administrator.
3. Access to the eastern portion of the sale involves crossing private property. The county has an easement to cross this property.
4. This contract requires County authorization for all road/landing construction and places a number other requirements on road construction and closure.
5. Decking of wood along town roads will not be allowed without permission from Bayfield County.

E. OTHER:

1. To comply with Best Management Practices for Invasive Species: Prior to moving equipment onto or off the sale area, scrape or brush soil and debris from exterior surfaces to the extent practical.

